

# HPCI BARRIER™ INSULATED METAL WALL PANEL

METL-SPAN INSULATED METAL PANELS

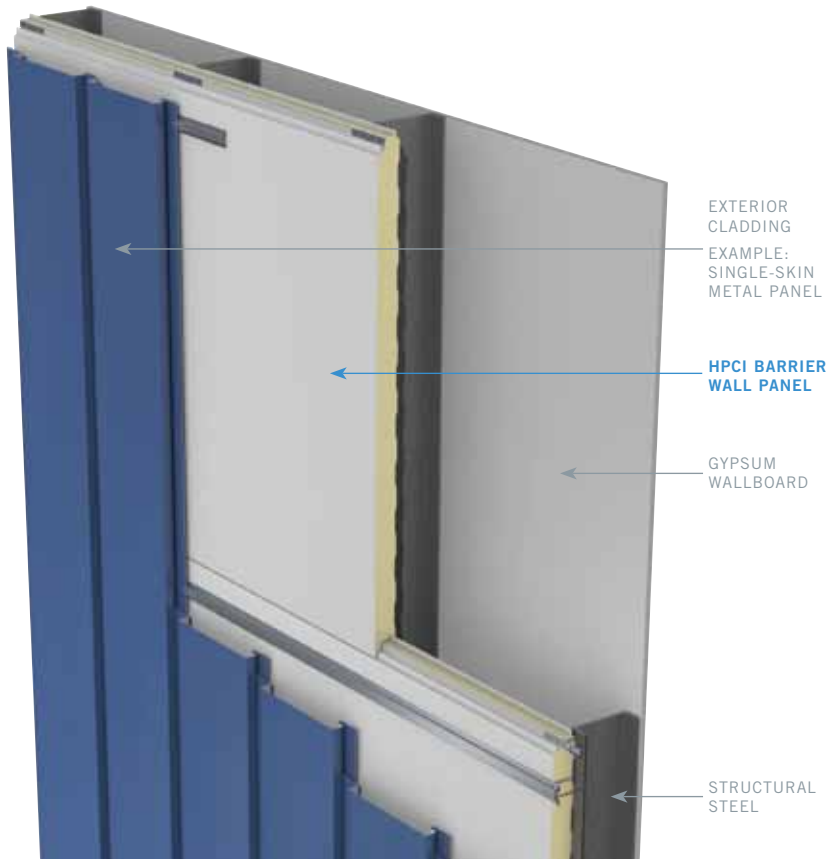

The HPCI Barrier™ insulated metal panel is an air, water, thermal and vapor barrier panel that can be used behind any type of facade. The HPCI Barrier back-up panel is installed in a horizontal orientation completely outside the structural supports. There are no thermal bridges to reduce the energy efficiency of the wall. HPCI Barrier is quick and easy to install and provides an economical solution to conventional air, water, thermal and vapor control without sacrificing thermal efficiency.



## HPCI BARRIER WALL PANEL FEATURES

**Exterior Profile:** No profile embossed

**Interior Profile:** Light Mesa embossed

**Panel Core:** Foamed-in-place, Non-CFC & zero ODP polyurethane

**Thermal Values:** K-factor, Btu in/ft<sup>2</sup> hr. °F @ 75°F (24°C)  
mean core temperature = 0.140

**Module Width:** 42"

**Panel Thickness:** 2", 3", 4"

**Panel Lengths:** 8'-0" to 24'-0"

**Exterior & Interior Facings:** Minimum .016" thick HPCI galvanized steel

**Color:** White polyester

**Panel Joint:** Offset double tongue and groove with extended metal shelf for positive face fastening

**Fastening:** Fastener and Clip concealed in the side joint  
Factory caulking available

**Oil Canning:** All flat metal surfaces can display waviness commonly referred to as "oil canning." "Oil canning" is an inherent characteristic of steel products, not a defect, and therefore is not a cause for panel rejection.

**Note:** The HPCI Barrier Panel must be separated from the interior of the building by an approved thermal barrier of .5" (12.7mm) gypsum wallboard to meet IBC requirements.

FSC Logo  
placement

**METL-SPAN:** Pioneering Insulated Metal Panel Technology  
1720 Lakepointe Drive, Suite #101, Lewisville, Texas 75057 • 877.585.9969 • FAX: 972.420.9382  
[metlspan.com](http://metlspan.com) • Visit our website or call us today for a free architectural catalog and CAD CD-ROM.